

1 Block A - Elevation A7
1 : 200

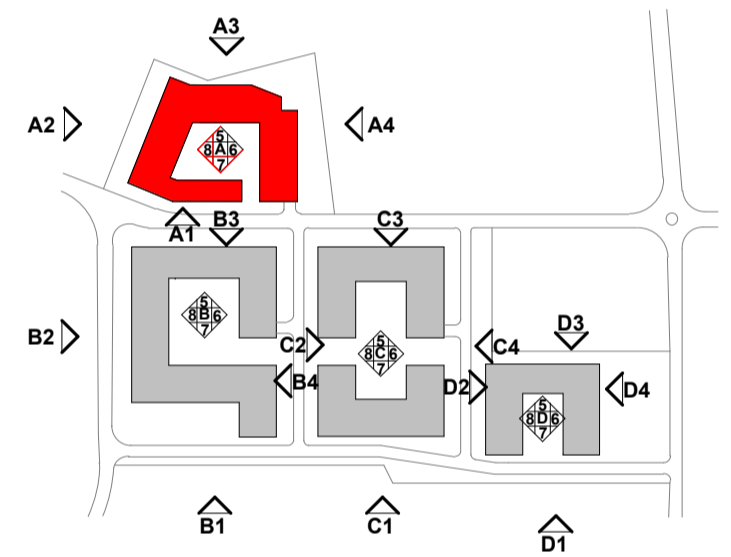

REV	DATE	SIGNED	NOTES

Project Stage

SHD Application

Client

Joseph Costello, Absolute Limousines Ltd and Boherkill Property Development Ltd.

Project

Lands west of Old Belgard Road and north, south and west of Cookstown Road, Cookstown Industrial Estate, Tallaght, Dublin 24

Drawing Title

BLOCK A - ELEVATIONS A7 & A8

Drawn	Checked	Scale @ A1	Date
AB	SOD	1 : 200	11/30/20

Project No.	Drawing No.
19127	2104

Drawing BIM Name:

P19127-CWO-01-ZZ-DR-A-2104

CDE Area	Suitability Code	Revision
	S2	



1 Sarsfield Quay, Arbour Hill, Dublin 7
t: 01 518 0170 e: admin@cwoarchitects.ie
Dublin | London | Warwick | Manchester
www.cwoarchitects.ie



2 Block A - Elevation A8
1 : 200